

FOR LEASE

4,303 SF | Corona, CA | Free-Standing, High-Image Single Story Office Building

Presented by Strata Realty, Inc. | www.stratarealty.com | T (951) 280-1733



4,303 SF FREE-STANDING OFFICE BUILDING PARTIALLY FURNISHED!!

Location

1871 California Avenue
Corona, CA 92881

Features

- Part of a 10 acre master-planned office park
- Open bullpen with twelve (12) cubicle stations
- Dramatic reception area
- Climate controlled server room
- Floor-to-ceiling glass conference room doors
- Eight (8) private offices
- Concrete construction with courtyard and two (2) private fountains
- Separate Men's and Women's restrooms
- Coffee bar/break room area
- Directly across from the South Corona post office and within walking distance to many retail amenities nearby
- Great access to 91 and I-15 freeways



Contact:

Timothy Hawke, SIOR

(951) 280-1733 | thawke@stratarealty.com

FOR LEASE

4,303 SF | Corona, CA | Free-Standing, High-Image Single Story Office Building

Contact: **Tim Hawke** | T (951) 280-1733

FLOOR PLAN

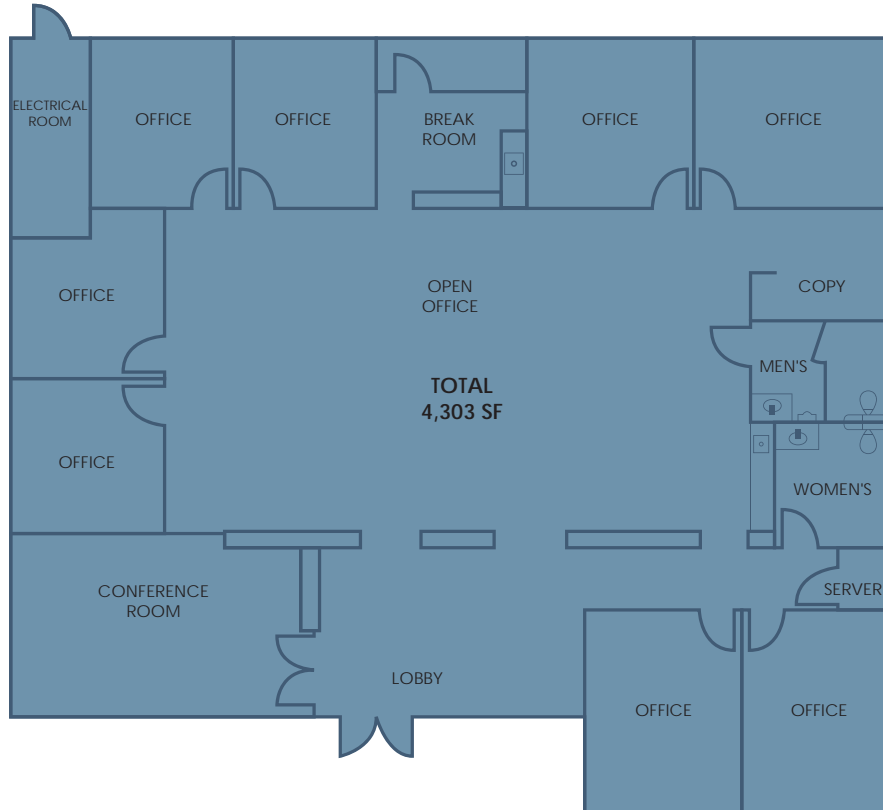

SITE PLAN

